

Solatube[®] HSE Skylight Remote Control User Manual



	Page
Remote Control Description	2
Remote Control Structure and Preparation	3
Control	3
Remote Control Menu Description	4
Add Device (Quick Start) Pair Remote to Skylight	5
Assign Remote As Secondary (Mirror / Clone Remote & Copy Group)	6—7
Remove Device From Network—Unpair Remote from Skylight	8
Reset Remote Control—Erase Memory from Remote	9
Additional Information—Information Codes	10
Troubleshooting	11—12
Note	13

Congratulations on the purchase of your new Solatube HSE Series Operable Skylight.

To ensure proper function of your new Solatube HSE Series Operable Skylight, please read this User Manual.

REMOTE CONTROL DESCRIPTION

The Solatube HSE Operable Skylight Remote Control is designed to control devices compatible with the Z-Wave platform of technologies for smart home capabilities. The remote control enables you to operate up to 12 devices in each of the 12 groups (a total of 144 devices). The currently selected group is marked with the appropriate number on the remote’s screen.

The Z-Wave network features division into PRIMARY and SECONDARY remote controls.

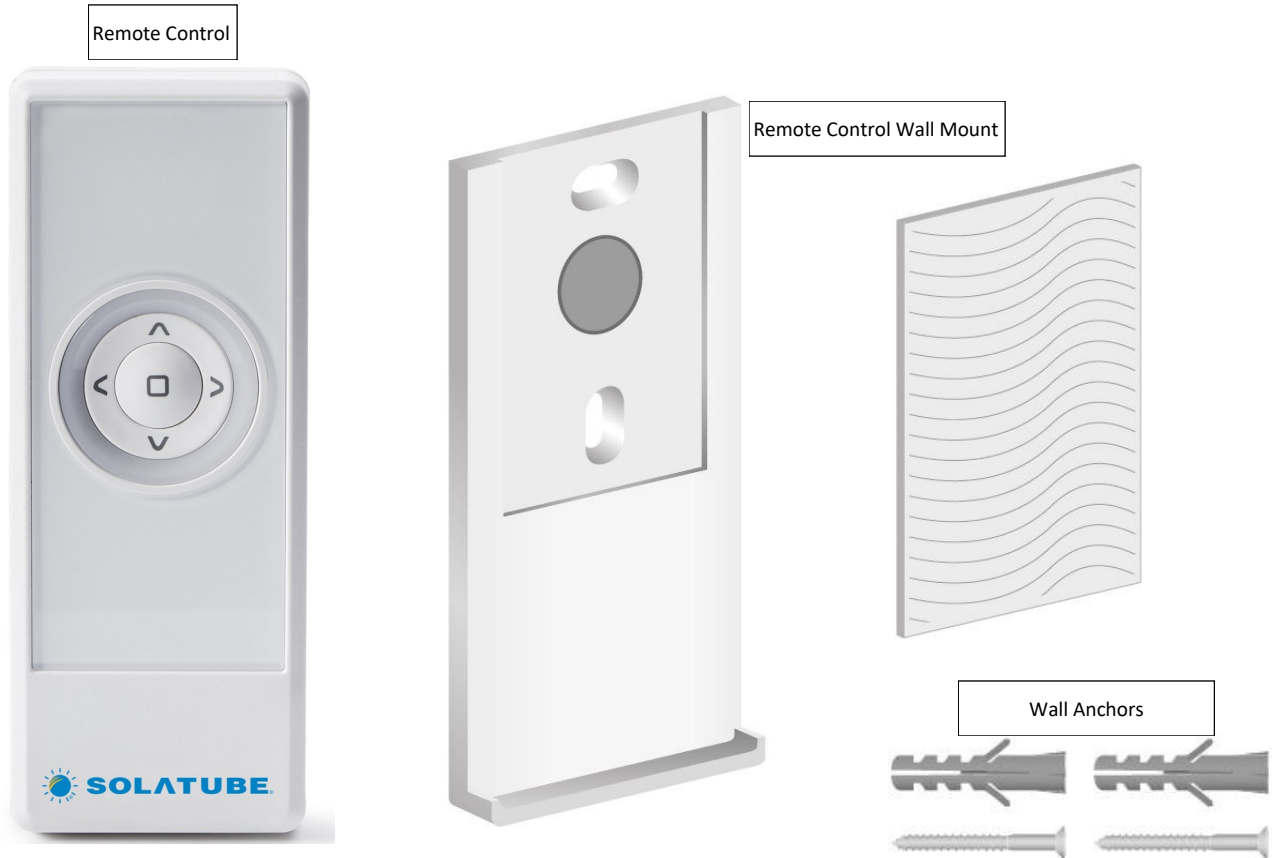

PRIMARY remote control—used to operate devices. It can add and remove devices. Only one PRIMARY remote control can be in one network.

SECONDARY remote control—used only to operate devices. Many SECONDARY remote controls can be in one network. Please note: these remotes must be associated with the primary remote. Only the primary remote can be paired directly to a skylight.

SPECIFICATIONS

Power Supply:	2 x 1.5v AAA
Reach:	Up to 20m in a building
Working Temperature:	0-40° C (32-104°F)
Dimensions:	125/48/16 mm
Radio Protocol:	Z-Wave
Frequency:	EU-868, 42 MHz AS/NZ—921, 42 MHz RU—869 MHz (Depending on version)



For the most current Installation Instructions, please visit www.solatube.com/instructions

Remote Control Structure

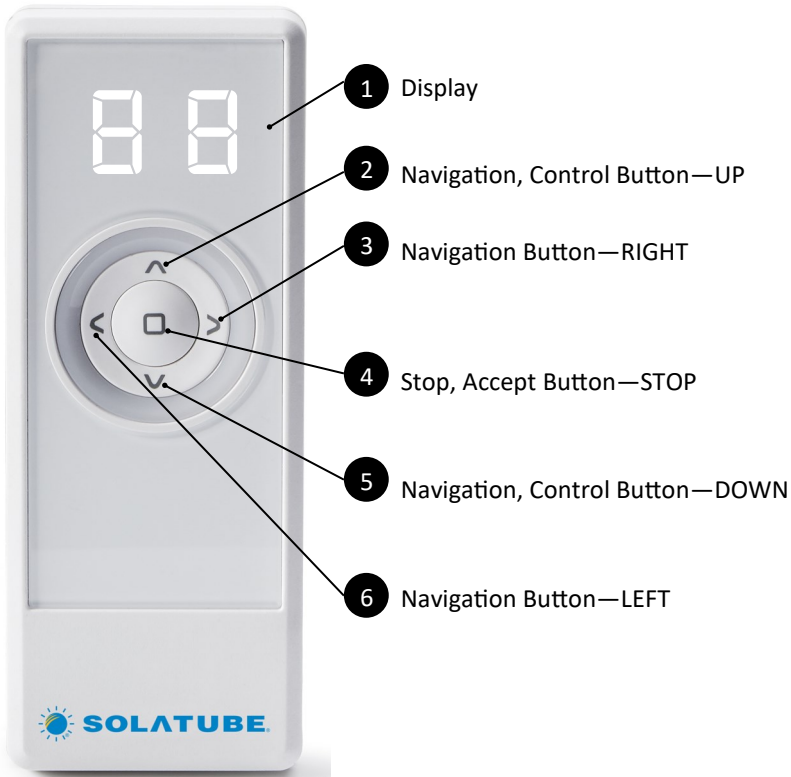

Remote Control Preparation



1. Slide down back cover of remote to remove battery cover.
2. Remove plastic battery protector
3. To replace battery cover, slide cover up and click into place.

Control

Control Modes



- 1 SHORT press of the control (less than half sec.) causes the action to reach end position.
- 2 LONG press of the control (longer than half sec.) causes the action until releasing the button.
- 3 Pressing STOP button stops the action

Device Control

Controlling devices using the Solatube remote control consists in controlling selected group of devices. If you want to control devices independently, they must be assigned to separate groups.

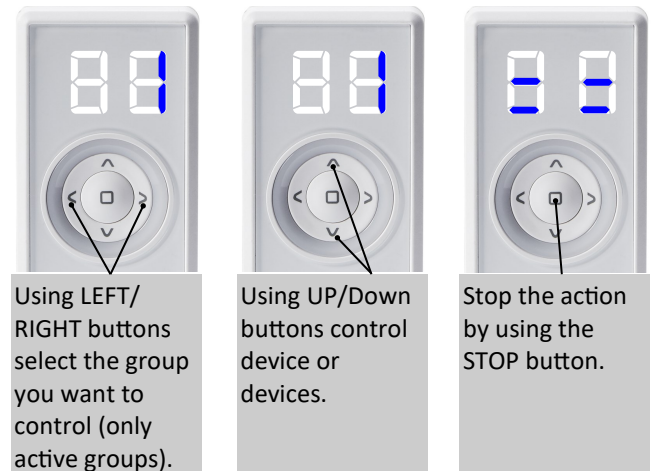

Remote Control Menu Description

The Solatube remote control is equipped with a hidden screen located under the front of the housing. This makes it easy to find the function that you are interested in. Abbreviations displayed on the screen are described below.

Holding Stop + Up Button for 3 Seconds



Quick Start / Adding Device (Quick Start)—
Adding devices both to network and group.

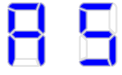

Associate / Adding Devices to Group.



Include / Adding Device to Network.

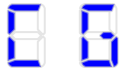

Copy Group—
Copying groups to other remote controls in the same network.



Assign A Route / Associating Devices—
Control signal is sent between associated devices.

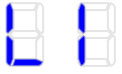

Listening Mode—
Enables remote configuration of the remote control from another controller.

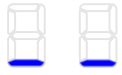

Back to Previous Screen.

Holding Stop + Down Button for 3 Seconds

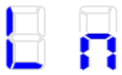

Learn Mode—
Enables to add the remote control to the network as Secondary.



Delete Mode / Removing Devices from Group



Delete Group / Removing Group—
Removes the entire selected group.



Exclude / Removing Device from Network.



Default / Resetting Remote Control—
Resets setting of the remote control and removes information about devices and network.

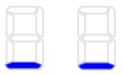

Back to Previous Screen.

For the most current Installation Instructions, please visit www.solatube.com/instructions

Solatube International, Inc. | 2210 Oak Ridge Way | Vista, CA 92081-8341 | www.solatube.com | T: 888.SOLATUBE

Add Device (Quick Start)

This function allows you to pair a remote to a skylight.

You can add multiple skylights to one remote by repeating this step for each skylight.

Each skylight can be added to one group or separate groups (i.e. group 1 can operate all skylights by selecting group 1 and repeating these steps, or each skylight can be added to individual groups by repeating these steps and selecting a new group (2, 3, 4...) for each skylight being added).



Hold simultaneously the UP and STOP buttons until the remote enters configuration mode.

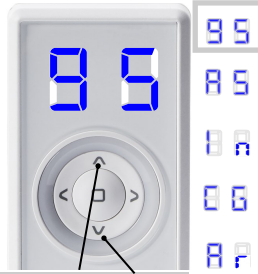

Using UP / DOWN buttons select marked position.

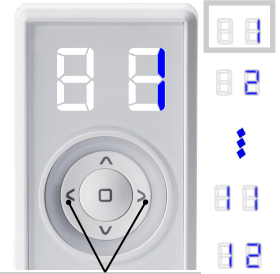

Using LEFT / RIGHT buttons select group to which you want to assign the device (e.g. 1)



Accept by pressing STOP button.



Display will begin to count down. Press "P" button on skylight being added within 12 seconds of countdown.

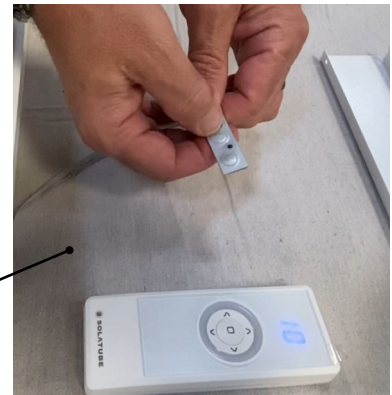

Procedure performed correctly. Blue backlight flashes once.



Error. Red backlight flashes 3 times. Repeat procedure or see page 11, point 1 or 2.

Assign Remote As Secondary (Mirror / Clone Remote) and Copy Group

This function allows you to assign a second remote control as a SECONDARY. This allows you to use two remote controls to operate skylights. Follow these steps if you want a secondary remote to do the same as the primary remote.

PLEASE NOTE: You must first unpair the secondary remote from the skylight (Page 8) and then erase memory from the secondary remote (Page 9) before performing the steps on this page.

Secondary



Hold simultaneously STOP and DOWN buttons until you enter configuration mode.

Secondary



Using UP / DOWN buttons select the marked positions.

Secondary



Accept by pressing STOP button.

Secondary



Display will begin to count down. Within 30 seconds complete the following steps on the Primary remote (Add DEVICE TO NETWORK)

Primary



Hold simultaneously the UP and STOP buttons until the remote enters configuration mode.

Primary

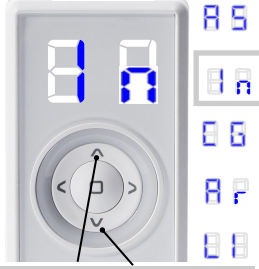

Using UP / DOWN buttons select marked position.

Primary



Accept by pressing STOP button.

Primary



Display will begin to count down.

Primary



Secondary



Procedure performed correctly. Blue backlight flashes once on Primary and Secondary remote controls.

The Secondary remote has now learned the Primary remote control. It is now necessary to copy the group from the Primary remote control to the Secondary remote.

Please proceed to next page (Page 7 Copy Group) to complete Cloning process.

Assign Remote As Secondary (Mirror / Clone Remote) and Copy Group Continued

This function allows you to assign a second remote control as a SECONDARY. This allows you to use two remote controls to operate skylights. Follow this step if you want a secondary remote to do the same as the primary remote.



Using LEFT / RIGHT buttons select group which you want to remove (e.g. 1).



Hold simultaneously UP and STOP buttons until you enter configuration mode.

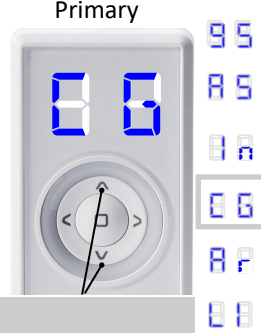

Using UP / DOWN buttons select marked position.

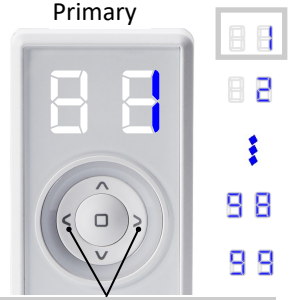

Using LEFT / RIGHT buttons select a target group.



Accept by pressing STOP button.



Display will begin to count down. Within 12 seconds run LISTENING MODE on the Secondary remote control.



Hold simultaneously STOP and UP buttons until you enter configuration mode.



Using UP and DOWN buttons select marked position.



Accept by pressing STOP button.



The remote control enters Listening Mode. Blue LEDs flash sequentially, Clockwise. The remote control remains in the Listening Mode for 30 seconds after the data transmission.

The Secondary remote has now Copied the selected Group from the Primary remote control and will operate the skylight(s).

Remove Device From Network Unpair Remote From Skylight

This step allows a remote to be removed from a skylight memory.



Hold simultaneously STOP and DOWN Buttons until you enter configuration mode.



Using UP / DOWN buttons select the marked positions.



Accept by pressing STOP button.



Display will begin to count down. Within 12 seconds press the "P" button of the skylight being unpaired.



Procedure performed correctly. Blue backlight flashes once.



Error. Red backlight flashes 3 times. Repeat procedure or see page 12, point 5.

Reset Remote Control Erase Memory from Remote

Removes all information from remote.



Hold simultaneously STOP and DOWN buttons until you enter configuration mode.



Using UP and DOWN buttons select marked position.



Accept by pressing STOP button.



Procedure performed correctly.
Blue backlight flashes once.

Additional Information

*1—Programming Mode

Programming mode is reached by pressing programming button on the device being added / removed. Solatube products have programming buttons marked with “P” letter.

Information Codes



No reach, programming button not pressed or a different primary remote has already been paired to this device.



Low remote control battery level.



Exit menu automatically.



Stop procedure (using stop button).



Group to which the device is to be added is full.



The battery level cannot be checked if more than one device is in the group. The device does not have batteries.



Group is empty.



WARNING STATUS: Low battery level. After pressing any button, that is after waking up the remote control, the symbol lights for 2 seconds. The device can still be controlled.

CRITICAL STATUS: Critical low battery level. The symbol lights for 2 seconds. In addition, red backlight flashes quickly for 2 seconds. The device cannot be controlled.

Troubleshooting

1. Device cannot be added to Z-Wave network.

Cause	Solution
Device is added to other Z-Wave network.	Removing Device From Network (page 8).
Programming button is not pressed.	Press programming button for 2 seconds.
Too long waiting for pressing programming button on the device.	Press programming button in time no longer than 12 seconds.
Controller is assigned to the network as SECONDARY.	Only PRIMARY controller can add and remove devices.

2. Device cannot be removed from the network.

Cause	Solution
Group is full (dot at group number, e.g. "1.").	Add device to another group.
Programming button is not pressed.	Press programming button for 2 seconds.
Too long waiting for pressing programming button on the device.	Press programming button in time no longer than 12 seconds.

3. Device cannot be removed from the group.

Cause	Solution
Programming button is not pressed.	Press programming button for 2 seconds.
Too long waiting for pressing programming button on the device.	Press programming button in time no longer than 12 seconds.

4. Group cannot be copied.

Cause	Solution
Too long waiting time for running LEARNING MODE on the target controller.	Run LEARNING MODE on the target controller no longer than 12 seconds.

Troubleshooting

5. Device cannot be removed from the network.

Cause	Solution
Programming button is not pressed.	Press programming button for 2 seconds.
Too long waiting time for pressing programming button on the device.	Press programming button in time no longer than 12 seconds.
Controller is assigned to the network as SECONDARY.	Only PRIMARY controller can add and remove devices.

6. ZRH12 remote control cannot be added as SECONDARY.

Cause	Solution
The controller being added is assigned to other Z-Wave network.	Restore controller being added to factory settings.
Too long waiting time for ADD DEVICE function on PRIMARY controller.	Run ADD DEVICE function on PRIMARY controller in time no longer than 12 seconds.

7. Device cannot be associated.

Cause	Solution
Devices cannot be associated in reverse order.	Repeat the procedure while maintaining the correct order of adding devices.
Too long waiting time for pressing programming button on the device.	Press programming button for no longer than 99 seconds.

8. Problems with reach.

Cause	Solution
Distance between device is too far or no power.	Check whether the device that you want to control is properly connected to the power source. This can be done by using manual control button.

Notes



Solatube International, Inc.,
2210 Oak Ridge Way, Vista CA 92081-8341
Phone (800) 966-7652 • Fax (760) 599-5181
www.solatube.com Part No. 951845 v1.1