

Garage Fan

Installation Instructions



Parts List *	Quantity
1 Garage Fan Assembly with Damper Box, Power Cord and Single Gang Junction Box	(1)
2 Fan Grille	(1)
3 Remote Control with receiver	(1)
4 Remote Wall Mount Cradle	(1)
5 Fastener Kit	
a. AAA Battery	(2)
b. Strain Relief	(1)
c. Cable Loop Clamp	(2)
d. Wall Anchor	(4)
e. Screw #8 x 2 in. Hex Head, Drill Tip	(2)
f. Screw #8 x 1.5 in. Hex Head, Drill Tip	(4)
g. Screw #6 x 1/2 in. Pan Head Phillips #2	(4)

Required Tools:

Keyhole Saw

Screw Gun with 1/4 in Nut Driver (Hex Head)

Tape Measure

Utility Knife

Screwdriver with Phillips Head

Pencil

Required Safety Equipment

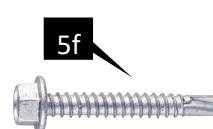
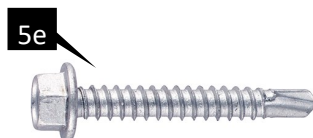
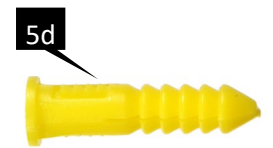

WARNING



Do not proceed with the installation until you have read the entire instructions, including these warnings. (Use of materials or methods not authorized by Solatube International will result in an invalid warranty.)

Solatube International, Inc. (seller) assumes no responsibility or obligation whatsoever for the failure of an architect, contractor, installer, or building owner to comply with all applicable laws, ordinances, building codes, electrical codes, energy codes, fire and safety codes and requirements, roof warranties and adequate safety precautions. Installation of this product should be attempted only by individuals skilled in the use of the tools and equipment necessary for installation. Protect yourself and all persons and property during installation. If you have any doubt concerning your competence or expertise, consult a qualified expert before proceeding. **Deviation from these instructions in any manner, including application and mounting, will result in a voided warranty.**

Install at your own risk!



Solatube product installations may be dangerous and include the potential for death, personal injury and property damage. The hazardous conditions include but are not limited to the following:

- Solatube Daylighting Systems, Solar Star products, and Whole House Fan ventilation systems may have sharp edges. Always wear leather or canvas gloves while handling and installing products.
- Solatube product installations require climbing and working at dangerous heights, including on ladders, scaffolding, roofs and in attic spaces. Risk of death, personal injury and property damage may result from a fall, or from falling objects. Use extreme caution to minimize risk of accidental injury, including, but not limited to the following procedures:
 - Clear area below your work space of all people, animals and other items.
 - Avoid working on surfaces that are slippery or wet.
 - Use foot-wear with excellent traction.
 - Use only strong, well supported ladders.
 - Work only in calm dry weather.
 - When in the attic, ensure that your weight is supported at all times with structurally sound framing; drywall material is not designed to carry a person's weight.
- To reduce the risk of fire, electric shock, and personal injury, basic safety precautions should always be followed when using electric tools, including always wearing safety goggles or other suitable eye protection, and ensuring work area is clear of all electrical wires, gas pipes, water pipes, and other obstacles.
- When working in the attic or other dusty areas, use of a mask or respirator is recommended to avoid lung irritation. Attic spaces may be dark, confined, and subject to extreme temperatures. Beware of sharp protruding objects. Do not attempt installation without having someone within range of your voice or close enough to come to your aid if necessary.
- Solatube products are not designed to withstand the weight of a person, tools or other objects. Walking or placing objects on the system could cause personal injury and property damage. If the product is damaged, the structural capacity may be weakened; therefore the system should be repaired immediately. For safe installation and use, do not deviate from these installation instructions.



Whole House Fan Installation Tips

These instructions are a step-by-step guide for the installation of Solatube Whole House Fan ventilation products in the following conditions.

PLEASE READ AND SAVE THESE INSTRUCTIONS

WARNING

To Reduce The Risk Of Fire Or Electric Shock, Do Not Use This Fan With Any Solid-State Speed Control Device. Electrical Connections Should Only be Performed By A Licensed Electrician.

To Reduce The Risk Of Fire, Electric Shock, Or Injury To Persons, Observe The Following:

- Use this unit only in the manner intended by the manufacturer. If you have questions, please contact your Solatube International representative.
- Before servicing or cleaning unit, switch power off at service panel and lock the service disconnecting means to prevent power from being switched on accidentally. When the service disconnecting means cannot be locked, securely fasten a prominent warning device, such as a tag, to the service panel.

Caution

- For General Ventilation Use Only. Do Not Use To Exhaust Hazardous or Explosive Materials and Vapors.
- Installation work and electrical wiring must be done by qualified persons (s) in accordance with all applicable codes and standards, including fire rated construction.
- Sufficient air is needed for proper combustion and exhausting of gases through the flue (chimney) of fuel burning equipment to prevent back drafting. Follow the heating equipment manufacturer's guidelines and safety standards such as those published by the National Fire Protections Association (NFPA), and the American Society for Heating, Refrigeration and Air Conditioning Engineers (ASHRAE), and local code authorities.
- When cutting or drilling into wall or ceiling, do not damage electrical wiring and other hidden utilities.
- If this unit is to be installed over a tub or shower, it must be marked as appropriate for the application and be connected to a GFCI (Ground Fault Circuit Interrupter) - Protection branch circuit.

For the most current Installation Instructions, please visit www.solatube.com/instructions

Overview

Locate Desired Placement of the Solatube Garage Fan

NOTE: The attic must be large enough to accommodate the Garage Fan in the chosen location. There must be a minimum vertical clearance of 16" from top of ceiling joist to roof rafter. Also, the attic or ceiling must have accessible power close enough to be able to plug in the fan or hard wire to existing electrical. i.e. garage door opener outlet.

NOTE: Please ensure that there is adequate net free ventilation for the Solatube Whole House Fan. You will need one (1) square foot of net free vent area for every 750 CFM of fan capacity.



WARNING

Avoid backdrafting of combustion appliances (i.e. gas fired water heaters and gas fired furnaces) by ensuring adequate ventilation is available and properly maintained. It is recommended to test the ventilation system to ensure intake and outlet ventilation is properly balanced. In some cases, it may be necessary to increase the number of vents to achieve this. When installing ventilation systems into a garage, it is recommended to test the system to ensure backdrafting is not occurring regardless of the amount of venting.

1

Mark Ceiling Locations for Damper Box Between Joists

Using a stud finder, locate ceiling joist near desired fan location and mark location. Use a keyhole saw to make two holes in the drywall against the edge of the joist. This will work as a guide for the template used in the next step. Ensure that one of the holes is used as the corner alignment and ensure the grill will be in the desired location on the ceiling.

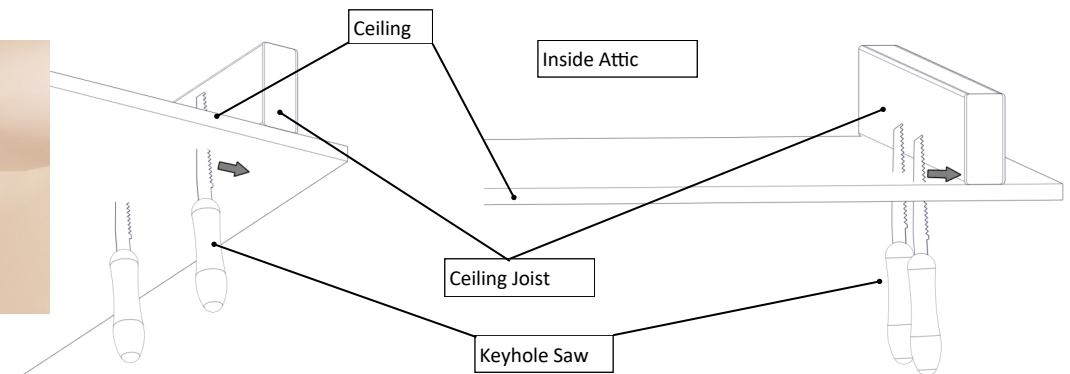

2

Create a Template

Place the Damper Box on the cardboard box and trace the outside edge onto the box. Next cut the template using a razor knife.

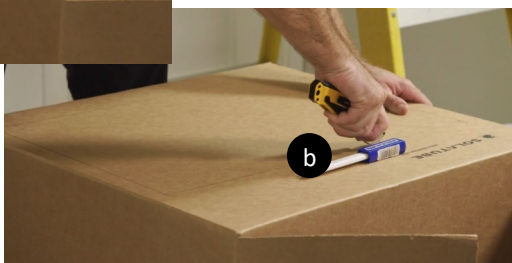

3

Trace Template onto Ceiling

Align the corner edge of template with one hole and the side with the second hole to ensure the opening will be aligned with the joist. Next trace the template to the Ceiling.

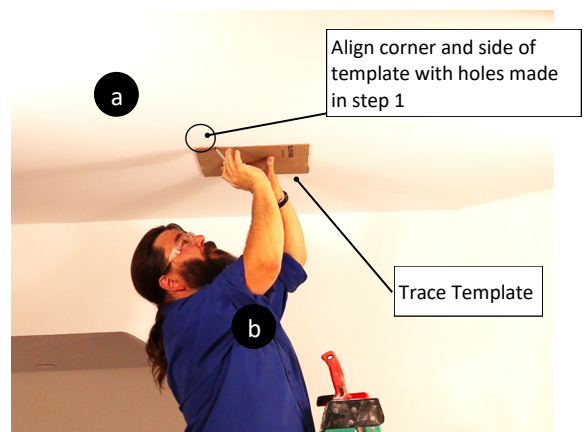

4

Cut Ceiling Hole

Using a keyhole saw, cut along traced line and remove cut ceiling piece.



5

Trace Junction Box

Take attached outlet/junction box and place in desired location of ceiling that is near existing garage door outlet box. Trace junction box onto ceiling.



6

Cut Junction Box Hole

Using a keyhole saw, cut along traced line and remove cut ceiling piece.



NOTE



Caution: Ensure the fire damper doors are open and the fusible link is engaged for proper operation of the fire dampers. Fire Dampers are required for all garage applications.

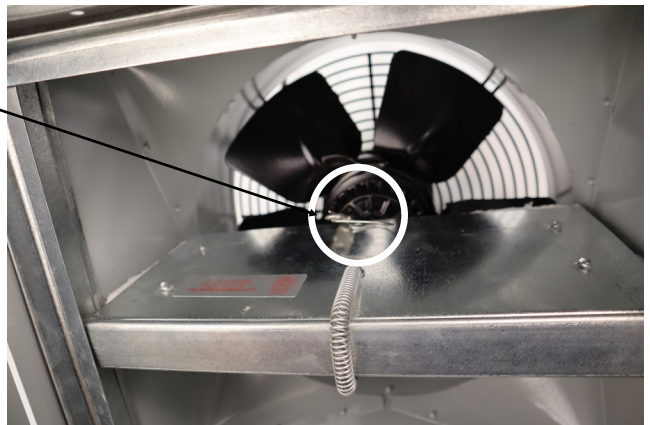

7 Insert Materials into Attic
Insert cord and attached junction box into ceiling. Carefully set junction box in close proximity to cut junction box opening. Insert fan into ceiling and set aside.

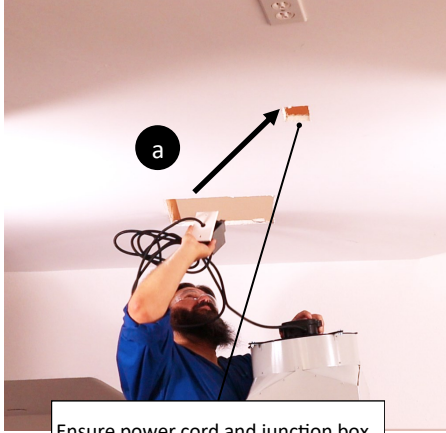

Ensure power cord and junction box will be accessible from box opening

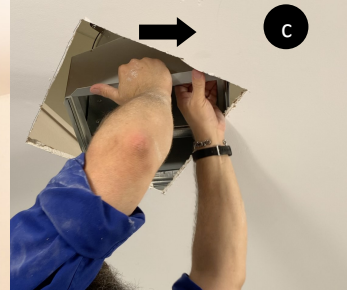
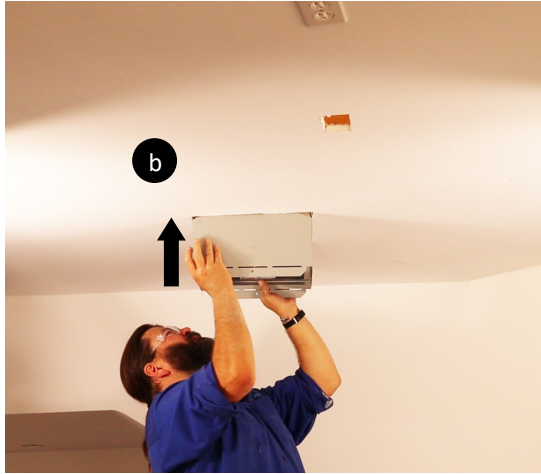

8 Bend Side Legs
Bend side legs 90 degrees

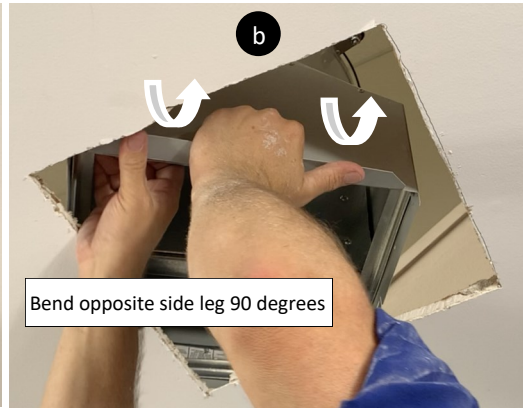
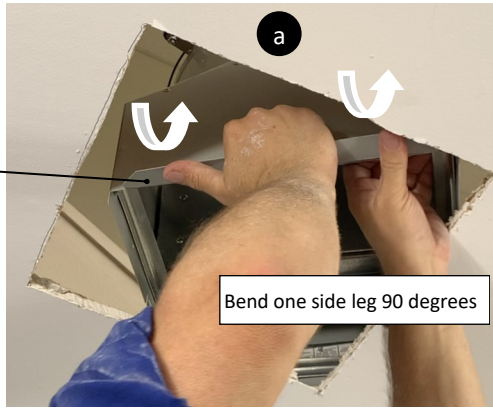
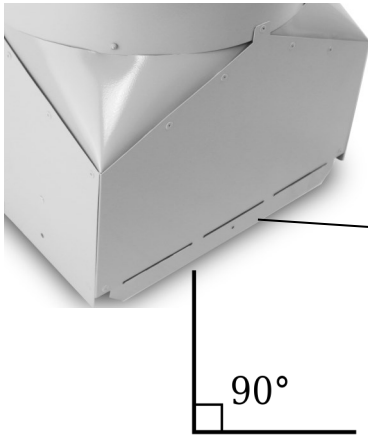

9 Center Fan into Opening
Position fan into opening with bent legs away from ceiling joist.

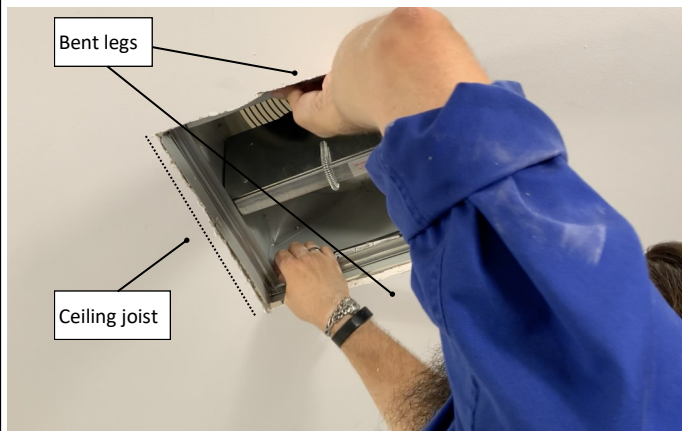

10 Fasten Fan to Ceiling Joist
Locate four (4) fastening holes on fan closest to ceiling joist and fasten to joist

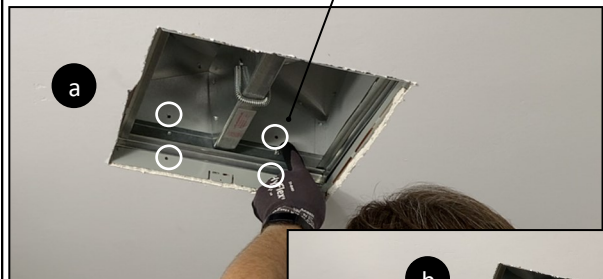

Screw #8 x 1.5 in. hex head

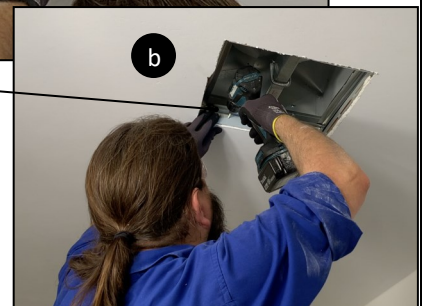

11

Install and Fasten Grille

Insert fan grille into ceiling with two (2) fastening holes facing bent legs.
Fasten grille to ceiling with provided fasteners.

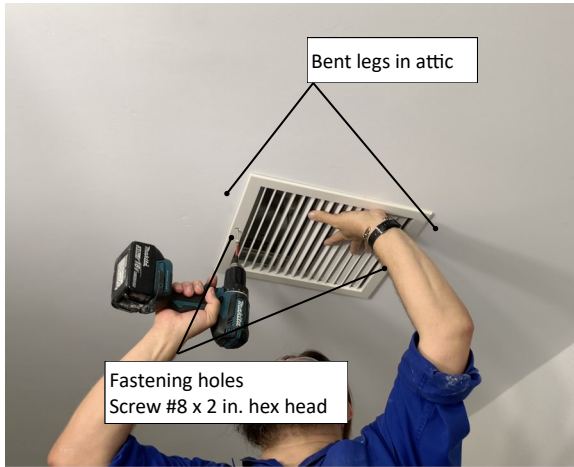

12

Adjust Grille Louvers

Adjust each individual louver to desired position.



13

Install Junction Box to Ceiling



Pull power cord through opening.

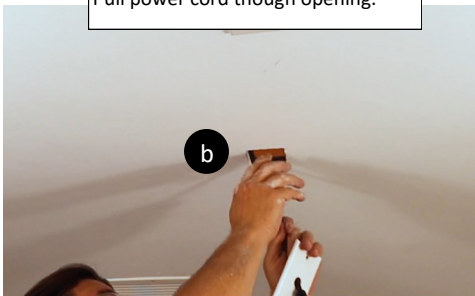

Carefully pull junction box through opening and re-insert.

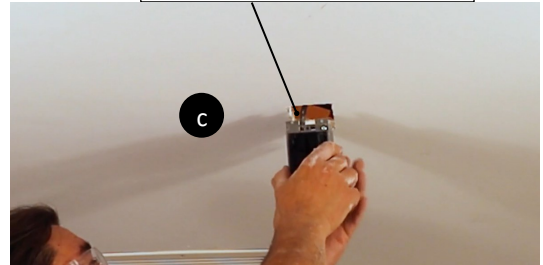

Fasten junction box to ceiling.

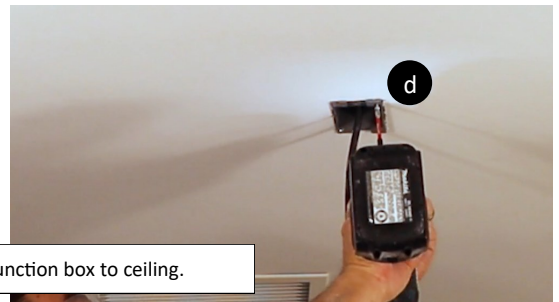

14

Adjust Power Cord and Install Box Cover



Adjust power cord to allow snug to ceiling and outlet box. Push excess cord back into junction box.

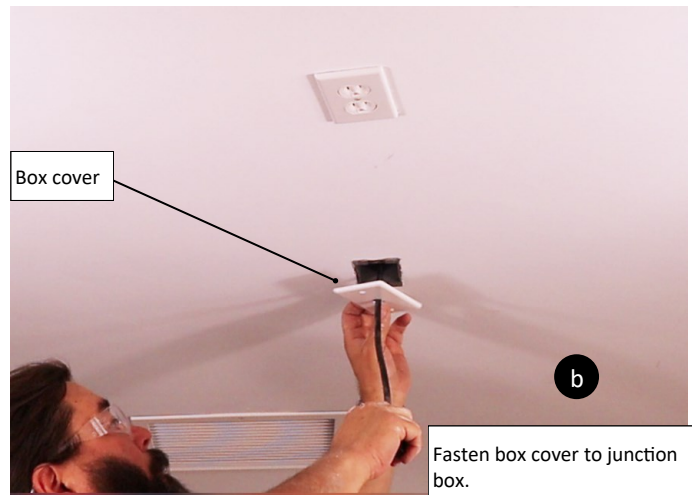

Fasten box cover to junction box.

For the most current Installation Instructions, please visit www.solatube.com/instructions

15

Install Receiver and Secure Power Cord Plug receiver and fan power cord into outlet box.

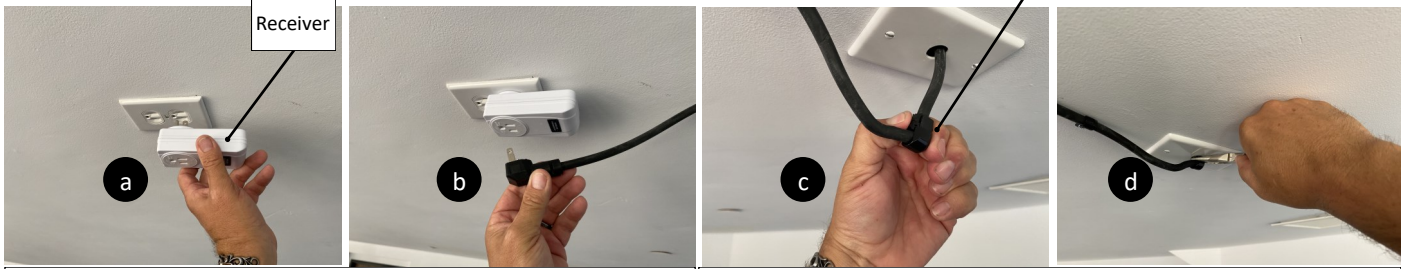

Plug receiver into outlet box then plug power cord into receiver.

Apply strain relief to power cord. Using pliers, pinch strain relief and secure into box cover.

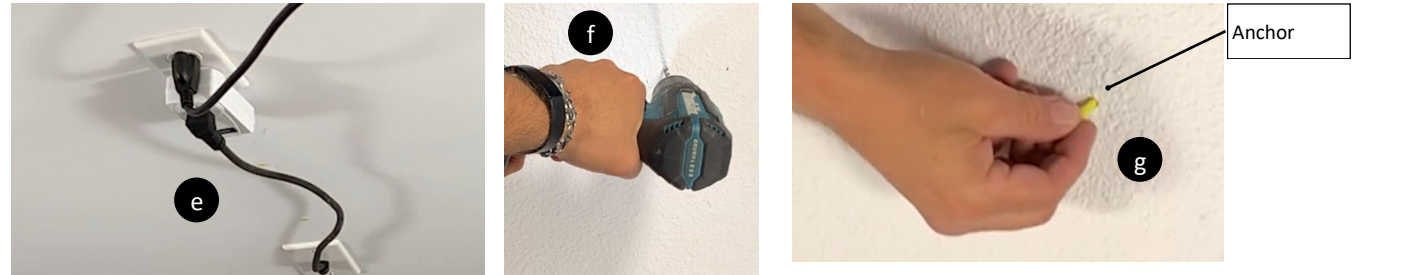

Position cord and cable clamps and drill hole into ceiling. Insert anchors into drilled holes.

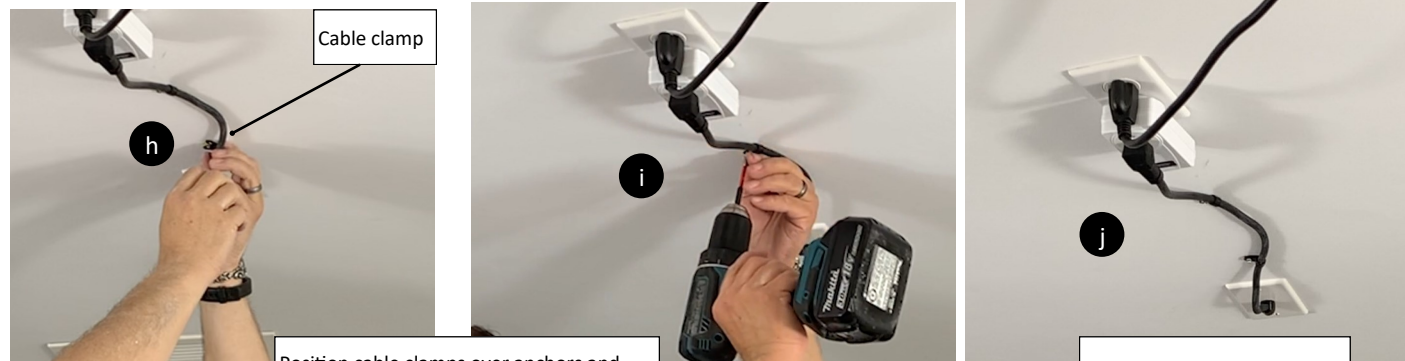

Position cable clamps over anchors and fasten with provided fasteners.

Completed cord installation.

16

Mount Remote to Wall Locate desired location on wall for remote cradle.

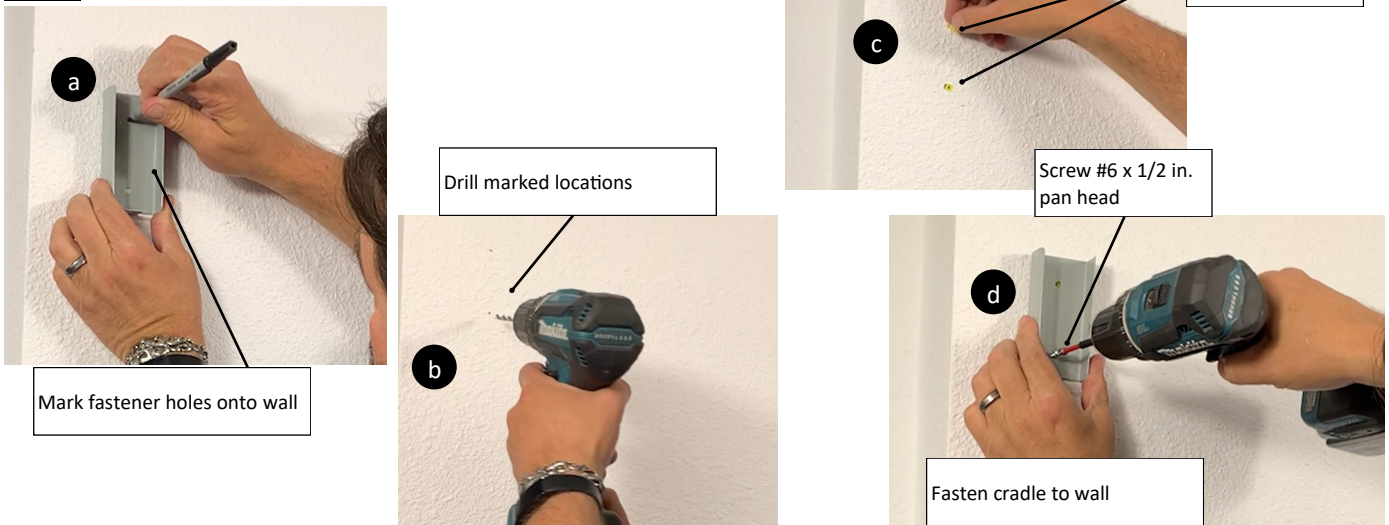

Mark fastener holes onto wall

Drill marked locations

Insert wall anchors

Screw #6 x 1/2 in. pan head

Fasten cradle to wall

17

Insert Remote to Cradle

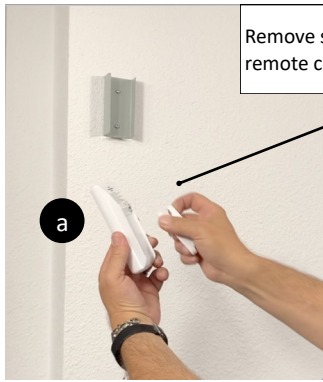

Remove swivel stand from back of remote control.



Place remote control into wall cradle.

18

Program Remote Control

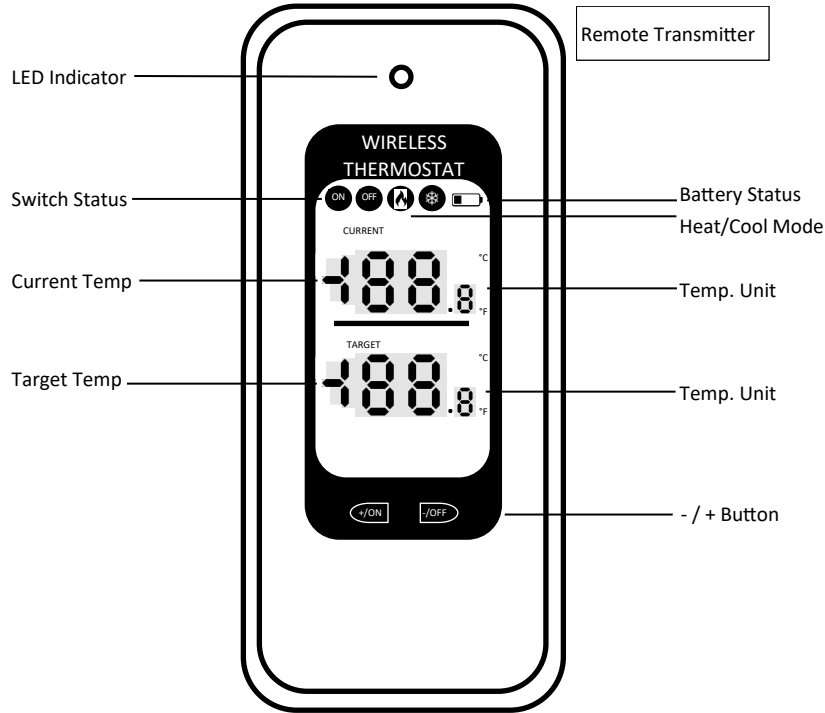

Remote Transmitter

19

Pairing Process

Step 1.

Plug Garage Fan power cord into receiver. The LED indicator will begin blinking indicating the receiver is in pairing mode. The receiver will remain in pairing mode for 30 seconds.

Step 2.

Place provided 2xAA batteries into the remote control. Place the remote controller near the receiver. The receiver will automatically communicate with the remote. The receiver will stop blinking once the remote is paired.

Ensure remote control is close to the receiver during this process without any blockage between the receiver and remote.

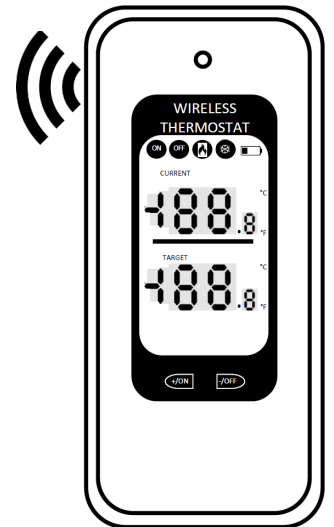
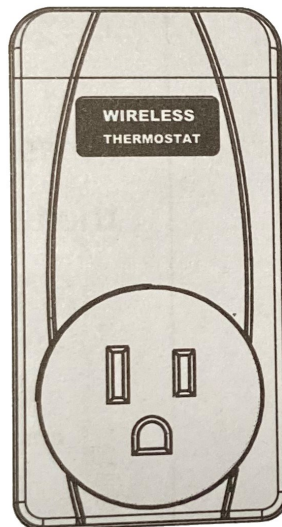

NOTE: If installing two (2) Garage fans in the same space, the receiver will communicate with the remote that is closest.



20

Program Remote Control Thermostat Setting

Step 1.

Press and hold +/- buttons together. The heat /cool  icon will flash.

Step 2.

Press - or + to toggle between heat and cold. Select cool  and hold - or + button for three seconds.

°F or °C will flash. Press - or + button to toggle between °F and °C. Select desired temperature measurement and hold - or + button for three seconds.

Press the - / + button to adjust the target temperature up or down. The target temperature is the temperature the fan will turn on or off.

Example: The fan will turn on if target temperature is set at 80°F and the current temperature raises above 80°F.
The fan will turn off if target temperature is set at 80°F and the current temperature falls below 80°F.

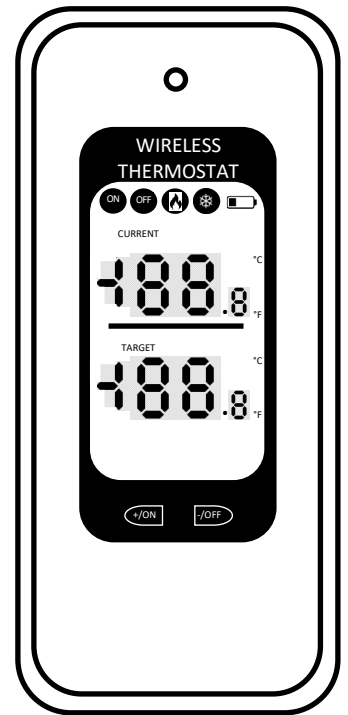

21

Program Remote Manual Mode

The Solatube Garage Fan can be used in manual mode and can be turned on or off as needed.

Turn Garage Fan to manual mode.

Press and hold +/ON button for five seconds. The fan will turn on and the remote will display ON. The target temperature will vanish in manual mode.

Turn Garage Fan off.

Press -/OFF button once to turn off Garage Fan.

Turn Garage Fan on.

Press +/ON button once to turn on Garage Fan.

To return to thermostat setting press and hold -/Off button for five seconds. Remote display will return to thermostat mode and target temperature will display again.

To reset settings press and hold both +/ON -/OFF buttons together for five seconds. The device will reboot and may reset setting shown in step 20.

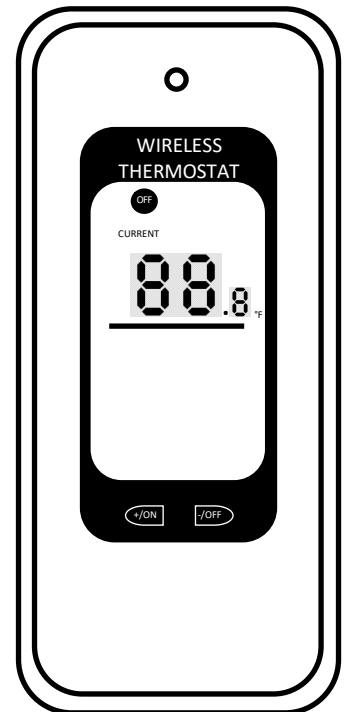
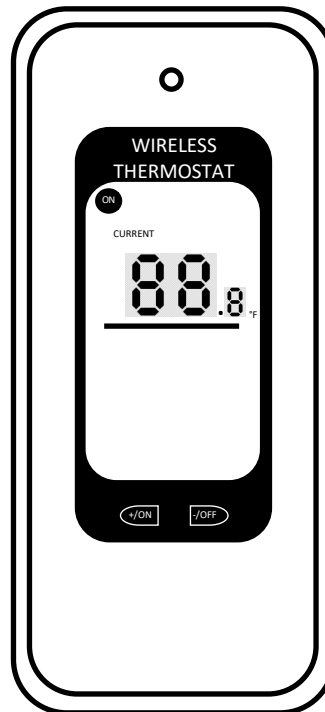

You may now enjoy the benefits of the Solatube Garage Fan and enjoy the fresh cool breeze.



Notes



Solatube International, Inc.,
2210 Oak Ridge Way, Vista CA 92081-8341
Phone (800) 966-7652 • Fax (760) 599-5181
www.solatube.com Part No. 941574 v1.1