



SOLATUBE
Innovation in Daylighting.

Solatube® SolaMaster® Series Rooftop Fire Glazing

Solatube® 330 DS / 750 DS

(Please refer to the SolaMaster Series main set of instruction (P/N: 950160) to complete the installation.)



Parts List *		Quantity
1	Rooftop Fire Glazing	(1)

Required Tools:

Screw Gun with Phillips Head

5/8 in (15.9mm) Hex Head bit

Required Safety Equipment

1

Install Rooftop Fire Glazing to Top Tube / Extension Tube
Place fire glazing onto tube and align tabs on fire glazing with tube notches.
Snap glazing clips into tube notches.

NOTE: The Rooftop Fire Glazing takes the place of the SolaMaster Tube Ring. The Tube Ring is not used for this application.

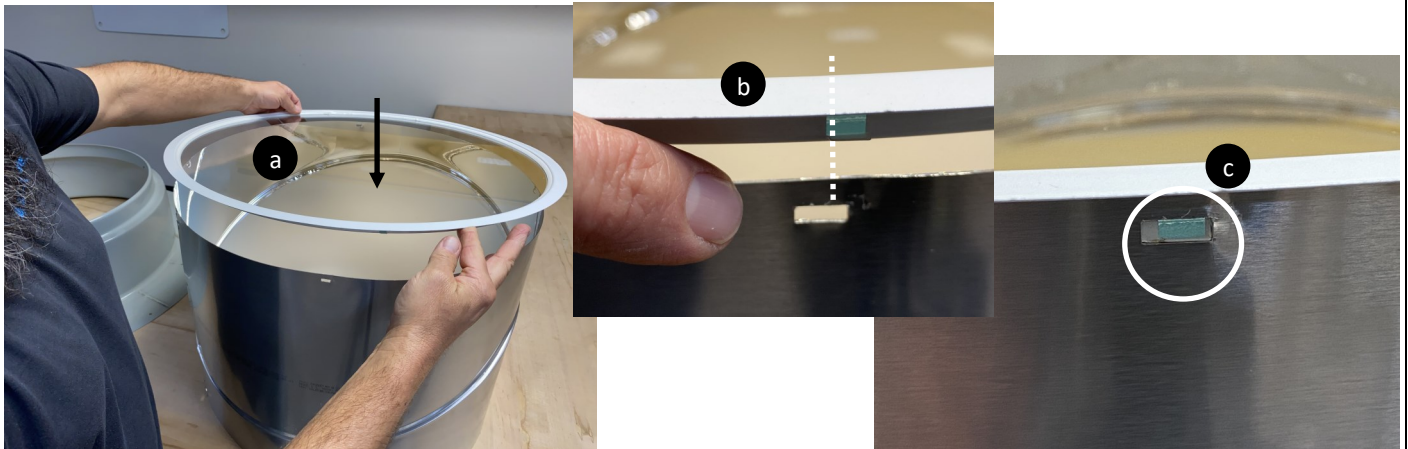

2

Insert Assembled Tube into Flashing.



Set assembled fire glazing and tubing onto flashing

Complete installation process, including dome and tube installation per Solatube SolaMaster Series Installation Instructions P/N: 950160.

Please Note: The Solatube Rooftop Fire Glazing must be used in conjunction with the Solatube Dome Edge Protection Band to meet the prescriptive method of option 1 of IBC 708A.2.1.

If local jurisdiction official needs assistance in understanding prescriptive acceptance, please contact Cal Fire or your Office of the State Fire Marshal as they can step them through the prescriptive process.

For the most current Installation Instructions, please visit www.solatube.com/instructions

Solatube International, Inc. | 2210 Oak Ridge Way | Vista, CA 92081-8341 | www.solatube.com | T: 888.SOLATUBE